

# TECHNICAL

GRZEGORZ TĘGOS

## Technika Napędu i Transmisji Mocy

[www.technical.pl](http://www.technical.pl)

e-mail: [biuro@technical.pl](mailto:biuro@technical.pl)

tel. +48 63 27 25 487; +48 63 26 16 257

**Koła pasowe Klinowe SPA**  
pod Taper Lock

# Dimensions of V-Pulleys PBT - mounting taper bushing SER-SIT®



## “PBT” SPA-A

dw [mm]	Number of grooves	Type	SER-SIT® Taper bushing	d min-max [mm]	M [mm]	L [mm]	Z [mm]	U [mm]	W [mm]
67	2	10	1108	11-28	-	22	13	37	35
71	1	1	1108	11-28	60	22	2	-	20
	2	10	1108	11-28	-	22	13	40	35
	3	10	1108	11-28	-	22	28	40	50
75	1	1	1108	11-28	60	22	2	-	20
	2	10	1108	11-28	-	22	13	44	35
	3	10	1108	11-28	-	22	28	44	50
80	1	1	1210	11-32	84	25	5	-	20
	2	10	1210	11-32	-	25	10	50	35
	3	10	1210	11-32	-	25	25	50	50
85	1	1	1210	11-32	88	25	5	-	20
	2	10	1210	11-32	-	25	10	55	35
	3	10	1210	11-32	-	25	25	55	50
90	1	1	1210	11-32	90	25	5	-	20
	2	10	1610	12-42	-	25	10	60	35
	3	10	1610	12-42	-	25	25	56	50
	4	10	1615	12-42	-	38	27	60	65
95	1	1	1210	11-32	90	25	5	-	20
	2	10	1610	12-42	-	25	10	62	35
	3	10	1610	12-42	-	25	25	62	50
	4	10	1615	12-42	-	38	27	62	65
100	1	1	1610	12-42	92	25	5	-	20
	2	10	1610	12-42	-	25	10	66	35
	3	2	1610	12-42	-	25	25	66	50
	4	2	1615	12-42	-	38	27	66	65
	5	2	1615	12-42	-	38	42	66	80
106	1	1	1610	12-42	85	25	5	-	20
	2	10	1610	12-42	-	25	10	72	35
	3	2	1610	12-42	-	25	25	72	50
	4	10	2012	14-50	-	32	33	72	65
	5	10	2012	14-50	-	32	48	72	80
112	1	1	1610	12-42	90	25	5	-	20
	2	10	1610	12-42	-	25	10	77	35
	3	10	2012	14-50	-	32	18	77	50
	4	10	2012	14-50	-	32	33	77	65
	5	10	2012	14-50	-	32	48	77	80
118	1	1	1610	12-42	96,4	25	5	-	20
	2	10	1610	12-42	-	25	10	85	35
	3	2	2012	14-50	-	32	18	85	50
	4	2	2012	14-50	-	32	33	85	65
	5	2	2012	14-50	-	32	48	85	80
125	1	1	1610	12-42	92	25	20	-	20
	2	10	1610	12-42	-	25	10	92	35
	3	2	2012	14-50	-	32	18	92	50
	4	2	2012	14-50	-	32	33	92	65
	5	11	2012	14-50	-	32	24	92	80
132	1	1	1610	12-42	92	25	5	-	20
	2	10	2012	14-50	-	32	3	97	35
	3	2	2012	14-50	-	32	18	97	50
	4	2	2517	18-65	-	45	20	97	65
	5	11	2517	18-65	-	45	17,5	102	80
140	1	1	1610	12-42	92	25	5	-	20
	2	10	2012	14-50	-	32	3	106	35
	3	10	2517	18-65	-	45	5	106	50
	4	2	2517	18-65	-	45	20	106	65
	5	11	2517	18-65	-	45	17,5	106	80

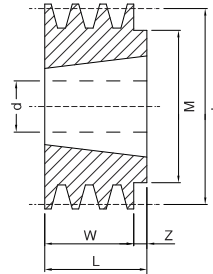

1

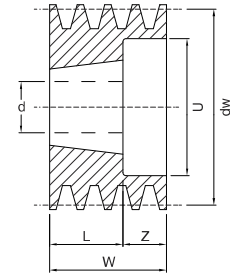

2

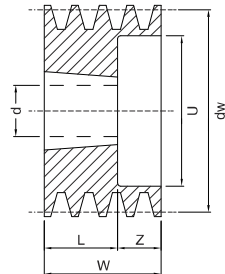

10

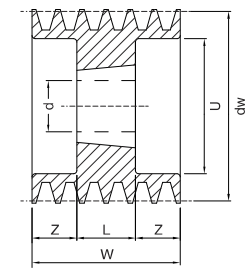

11

# Dimensions of V-Pulleys PBT - mounting taper bushing SER-SIT®



» "PBT" SPA-A

dw [mm]	Number of grooves	Type	SER-SIT® Taper bushing	d min-max [mm]	M [mm]	L [mm]	Z [mm]	U [mm]	W [mm]
150	1	4	1610	12-42	92	25	5	-	20
	2	10	2012	14-50	-	32	3	116	35
	3	10	2517	18-65	-	45	5	116	50
	4	2	2517	18-65	-	45	20	116	65
	5	11	2517	18-65	-	45	17,5	116	80
160	1	4	1610	12-42	92	25	5	-	20
	2	10	2012	14-50	-	32	3	126	35
	3	10	2517	18-65	-	45	5	126	50
	4	2	2517	18-65	-	45	20	126	65
	5	11	2517	18-65	-	45	17,5	126	80
170	1	4	1610	12-42	92	25	5	-	20
	2	10	2012	14-50	-	32	3	135	35
	3	10	2517	18-65	-	45	5	135	50
	4	2	2517	18-65	-	45	20	135	65
	5	11	2517	18-65	-	45	17,5	135	80
180	1	4	1610	12-42	92	25	5	146	20
	2	6	2012	14-50	108	32	1,5	146	35
	3	10	2517	18-65	-	45	5	146	50
	4	2	2517	18-65	-	45	20	146	65
	5	11	3020	22-75	-	51	14,5	146	80
190	1	4	1610	12-42	92	25	5	156	20
	2	6	2012	14-50	108	32	1,5	156	35
	3	10	2517	18-65	-	45	5	156	50
	4	2	2517	18-65	-	45	20	156	65
	5	2	3020	22-75	-	51	29	156	80
200	1	4	2012	14-50	108	32	12	165	20
	2	12	2517	18-65	123	45	5	165	35
	3	6	2517	18-65	123	45	2,5	165	50
	4	2	3020	22-75	-	51	14	165	65
	5	11	3020	22-75	-	51	14,5	165	80
212	1	4	2012	14-50	110	32	12	178	20
	2	4	2517	18-65	120	45	10	178	35
	3	6	2517	18-65	123	45	2,5	189	50
	4	2	3020	22-75	-	51	14	178	65
224	1	7	2012	14-50	112	32	12	189	20
	2	4	2517	18-65	124	45	10	189	35
	3	6	2517	18-65	124	45	2,5	189	50
	4	2	3020	22-75	-	51	14	189	65
	5	2	3020	22-75	-	51	29	189	80
236	1	7	2012	14-50	110	32	12	203	20
	2	7	2517	18-65	124	45	10	203	35
	3	9	2517	18-65	124	45	2,5	203	50
	4	6	3020	22-75	146	51	7	203	65
	5	6	3020	22-75	155	51	14,5	203	80
250	1	3	2012	14-50	112	32	6	215	20
	2	3	2517	18-65	124	45	5	215	35
	3	9	2517	18-65	124	45	2,5	215	50
	4	6	3020	22-75	159	51	7	215	65
	5	6	3020	22-75	159	51	14,5	215	80
280	1	7	2012	14-50	110	32	10	246	20
	2	7	2517	18-65	120	45	10	246	35
	3	9	2517	18-65	124	45	2,5	246	50
	4	9	3020	22-75	146	51	7	246	65
	5	12	3535	25-90	175	89	4,5	246	80
300	1	7	2012	14-50	112	32	12	266	20
	2	7	2517	18-65	124	45	10	266	35
	3	7	3020	22-75	146	51	1	266	50
	4	9	3020	22-75	146	51	7	266	65
	5	4	3535	25-90	175	89	9	266	80

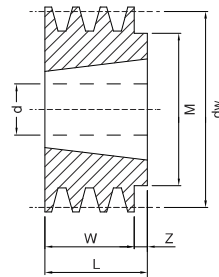

1

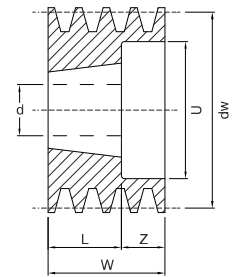

2

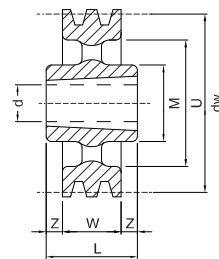

3

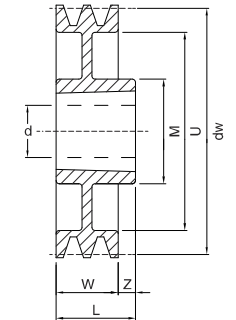

4

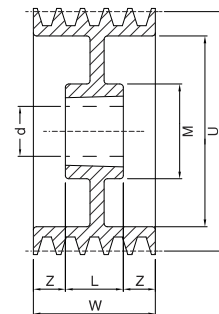

6

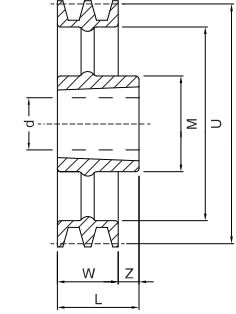

7

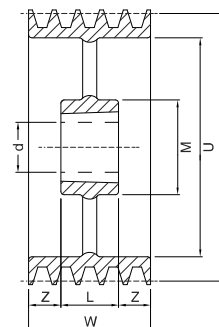

9

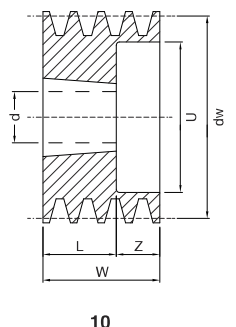

10

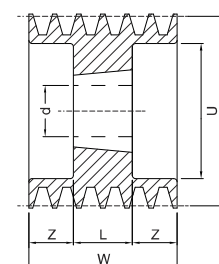

11

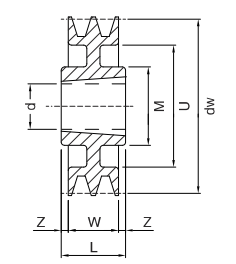

12

